



**FITTING INSTRUCTIONS FOR CLG0023CG/LH FACTORY CARBON LEVER DEFENDER
BMW S1000RR 19-**



**THIS KIT CONTAINS THE ITEMS PICTURED AND LABELLED BELOW.
DO NOT PROCEED UNTIL YOU ARE SURE ALL PARTS ARE PRESENT.**

PLEASE NOTE THAT THE WAY THE KIT IS PACKED DOES NOT NECESSARILY REPRESENT THE WAY OF MOUNTING TO THE BIKE

PLEASE NOTE THAT IN CASES WHERE KITS ARE PACKED WITH RUBBER WASHERS HOLDING THE COMPONENTS ONTO THE BOLT – *THE RUBBER WASHERS SHOULD BE THROWN AWAY!*

THE PARTS SHOWN MAY BE REPRESENTATIVE ONLY (FOR CLARITY OF INSTRUCTIONS ONLY)

DIGITAL COPIES OF THESE INSTRUCTIONS ARE AVAILABLE TO DOWNLOAD FROM WWW.RG-RACING.COM

GENERAL TORQUE SETTINGS

M4 BOLT = 8Nm
M5 BOLT = 12Nm
M6 BOLT = 15Nm
M8 BOLT = 20Nm
M10 BOLT = 40Nm

TOOLS REQUIRED

- T40 Torx Key/Socket
- 24mm A/F Hex Spanner
- 4mm A/F Allen Key

THIS KIT CONTAINS:

- Item 1 = 1x CARBON LEVER GUARD (LG0006COMP).
Item 2 = 1x MOUNTING SLEEVE (M0586)
Item 3 = 1x MOUNTING BLOCK (M0585)
Item 4 = 1x CONE SPACER (S0781)
Item 5 = 1x CLAMP SPACER (S0928)
Item 6 = 1x M6 x 1.00 x 50mm LONG STAINLESS-STEEL COUNTERSINK BOLT

R&G

Unit 1, Shelley's Lane, East Worldham, Alton, Hampshire, GU34 3AQ

Tel: +44 (0)1420 89007 Fax: +44 (0)1420 87301 www.rg-racing.com Email: info@rg-racing.com

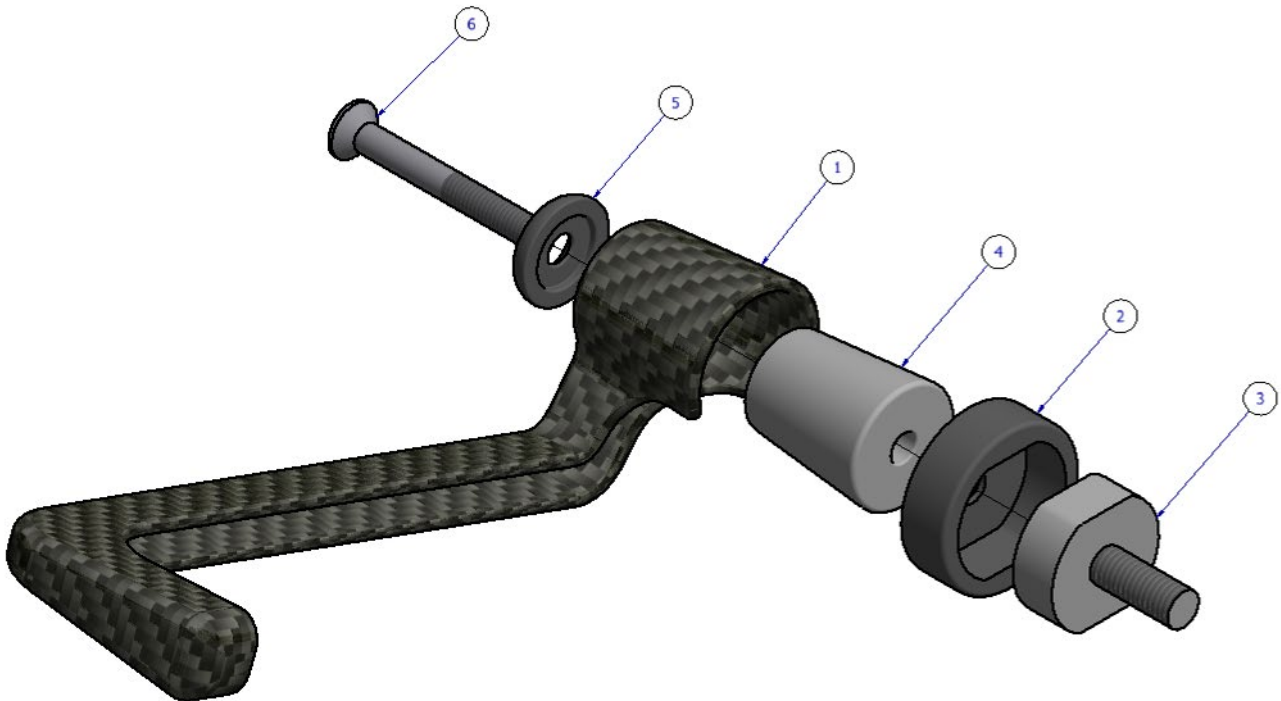

LEVER GUARD EXPLODED ASSEMBLY

- Remove the RHS OEM bar-end using a T40 Torx key/socket.
- Fit the mounting block (item 3) into the vacant M8 hole by winding in by hand, then tighten using a 24mm spanner across the flat faces of the block.
- Pre-assemble the lever guard as shown in the diagram above. Slide the cone spacer (item 4) into the bore of the lever guard (item 1), then push the countersink bolt (item 6) through the clamp spacer (item 5) and through the hole in the lever guard.
- Finally, assemble the lever guard as shown in the diagram above. Slide the sleeve (item 2) over the block, then secure the pre-assembled lever guard to the block using a 4mm Allen key and position so when the motorcycle is at full lock in both directions it does not contact any other part of the motorcycle.
- Fully tighten the bolt and check operation.

IMPORTANT: - WHEN FITTING THIS PRODUCT IT IS YOUR RESPONSIBILITY TO ENSURE THAT THE PRODUCT IN NO WAY IMPEDES THE OPERATION OF THE MOTORCYCLE AND IS CHECKED REGULARLY FOR TIGHTNESS AND OPERATION.

FAILURE TO CHECK THE ABOVE COULD RESULT IN SERIOUS INJURY OR DAMAGE.

ISSUE 1 - 10/01/2022

R&G

Unit 1, Shelley's Lane, East Worldham, Alton, Hampshire, GU34 3AQ

Tel: +44 (0)1420 89007 Fax: +44 (0)1420 87301 www.rg-racing.com Email: info@rg-racing.com

**CONSUMER NOTICE**

The catalogue description and any exhibition of samples are only broad indications of the Products and R&G may make design changes which do not diminish their performance or visual appeal and supplying them in such state shall conform to the order. The Buyer acknowledges no representation or warranty (other than as to title) has been given or will apply to the Products other than those in R&G's order or confirmation and the Buyer confirms it has chosen the Products as being of merchantable quality and suitable for its particular purposes. Where R&G fits the Products or undertakes other services it shall exercise reasonable skill and care and rectify any fault free of charge unless the workmanship has been disturbed. The Buyer is responsible for ensuring that the warranty on the motorcycle is not affected by the fitting of the Products. On return of any defective Products R&G shall at its option either supply a replacement or refund the purchase money but shall not be liable if the Products have been modified or used or maintained otherwise than in accordance with R&G's or manufacturer's instructions and good engineering practice or if the defect arises from accident or neglect. Other than identified above and subject to R&G not limiting its liability for causing death and personal injury, it shall not be liable for indirect or consequential loss and otherwise its liability shall be limited to the amounts paid by the Buyer for the Products or the fitting or service concerned. These terms do not affect the Buyer's statutory rights.

R&G RACING RETURNS POLICY (NON-FAULTY GOODS)

Returns must be pre-authorized (if not pre-authorized the return will be rejected). Goods may only be returned direct to us if they were purchased direct from us (customer must prove if necessary). Otherwise to be returned to original vendor. Goods must be in re-sellable condition, in the opinion of R&G Racing. All returns are subject to a 25% restocking and handling fee (25% of the gross value exc. P&P – at the prevailing price at time of purchase). The customer must pay any and all carriage charges. No returns of discontinued products, unless within 14 days of purchase. This policy does not affect your statutory rights and does not refer to faulty goods.

R&G

Unit 1, Shelley's Lane, East Worldham, Alton, Hampshire, GU34 3AQ

Tel: +44 (0)1420 89007 Fax: +44 (0)1420 87301 www.rg-racing.com Email: info@rg-racing.com



INSTRUCTIONS DE MONTAGE POUR CLG0023CG/LH DEFENDER À LEVIER DE CARBONE
D'USINE
BMW S1000RR 19-



LE KIT CONTIENT LES ARTICLES EXPOSÉS CI-DESSOUS, VÉRIFIER QUE TOUTES LES PIÈCES SOIENT PRÉSENTES AVANT DE PROCÉDER AU MONTAGE.

LA FAÇON DONT LE KIT EST EMBALLÉ NE CORRESPOND PAS FORCÉMENT À LA FAÇON DE MONTER LES PIÈCES SUR LA MOTO.

NOTEZ QUE SI LES KITS SONT EMBALLÉS AVEC DES RONDELLES EN CAOUTCHOUC SERVANT À TENIR LES COMPOSANTS, *CES RONDELLES DOIVENT ÊTRE JETÉES!*

LES PARTIES PRÉSENTÉES PEUVENT ÊTRE UNIQUEMENT REPRESENTATIVES (POUR LA CLARTE DES INSTRUCTIONS UNIQUEMENT)

NOTICE DISPONIBLE AU TÉLÉCHARGEMENT SUR WWW.RG-RACING.COM

VALEURS DE SERRAGE RECOMMANDÉES

M4 BOULON = 8Nm
M5 BOULON = 12Nm
M6 BOULON = 15Nm
M8 BOULON = 20Nm
M10 BOULON = 40Nm

OUTILS REQUIS

- Clé Torx T40
- Clé à molette 24mm
- Clé Allen 4mm

LE KIT CONTIENT :

Article 1 = 1x PROTECTION POIGNEE EN FIBRE DE CARBONE (LG0006COMP).
Article 2 = 1x MANCHON (M0586)
Article 3 = 1x BLOC DE MONTAGE (M0585)
Article 4 = 1x ENTRETOISE CONIQUE (S0781)
Article 5 = 1x ENTRETOISE (S0928)
Article 6 = 1x M6 x 1.00 x 50mm BOULON

R&G

Unit 1, Shelley's Lane, East Worldham, Alton, Hampshire, GU34 3AQ
Tel: +44 (0)1420 89007 Fax: +44 (0)1420 87301 www.rg-racing.com Email: info@rg-racing.com

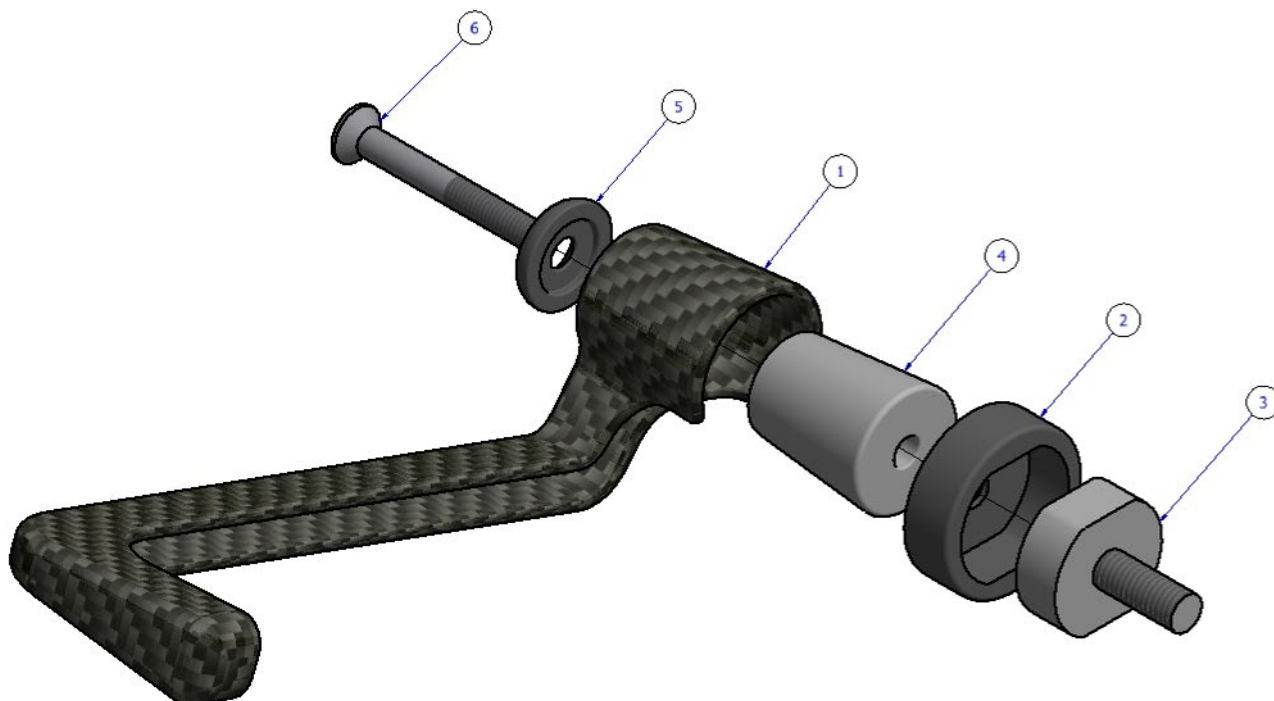

MONTAGE DE LA PROTECTION LEVIER

- Retirez l'extrémité de guidon d'origine du côté droit à l'aide d'une clé / douille Torx T40.
- Insérez le bloc de montage (article 3) dans le trou M8 vacant en le remontant à la main, puis serrez à l'aide d'une clé plate de 24 mm sur les faces planes du bloc.
- Prémontez le protège-levier comme indiqué sur le schéma ci-dessus. Faites glisser l'entretoise conique (article 4) dans l'alésage du protège-levier (article 1), puis poussez le boulon (article 6) à travers l'entretoise de serrage (article 5) et à travers le trou du protège-levier.
- Enfin, assemblez le protège-levier comme indiqué sur le schéma ci-dessus. Faites glisser le manchon (article 2) sur le bloc, puis fixez le protège-levier pré-assemblé au bloc à l'aide d'une clé Allen de 4 mm et positionnez-le de sorte que, lorsque le guidon de la moto est complètement verrouillée dans les deux sens, elle ne touche aucune autre partie de la moto.
- Serrez complètement le boulon et vérifiez son fonctionnement.

IMPORTANT : - IL EST DE VOTRE RESPONSABILITE DE CONTROLER QUE CE PRODUIT NE GENERA PAS LE FONCTIONNEMENT DE LA MOTO, ET DE VERIFIER REGULIEREMENT SON SERRAGE.
NE PAS EFFECTUER CES VERIFICATIONS PEUT CAUSER DES DOMMAGES POUR LA MOTO ET SON PILOTE.

ISSUE 1 - 10/01/2022

R&G

Unit 1, Shelley's Lane, East Worldham, Alton, Hampshire, GU34 3AQ
Tel: +44 (0)1420 89007 Fax: +44 (0)1420 87301 www.rg-racing.com Email: info@rg-racing.com

CONSUMER NOTICE

The catalogue description and any indications of the Products and R&G may diminish their performance or visual appeal conform to the order. The Buyer warranty (other than as to title) has been given or will apply to the Products other than those in R&G's order or confirmation and the Buyer confirms it has chosen the Products as being of merchantable quality and suitable for its particular purposes. Where R&G fits the Products or undertakes other services it shall exercise reasonable skill and care and rectify any fault free of charge unless the workmanship has been disturbed. The Buyer is responsible for ensuring that the warranty on the motorcycle is not affected by the fitting of the Products. On return of any defective Products R&G shall at its option either supply a replacement or refund the purchase money but shall not be liable if the Products have been modified or used or maintained otherwise than in accordance with R&G's or manufacturer's instructions and good engineering practice or if the defect arises from accident or neglect. Other than identified above and subject to R&G not limiting its liability for causing death and personal injury, it shall not be liable for indirect or consequential loss and otherwise its liability shall be limited to the amounts paid by the Buyer for the Products or the fitting or service concerned. These terms do not affect the Buyer's statutory rights.



exhibition of samples are only broad make design changes which do not and supplying them in such state shall acknowledge no representation or

R&G RACING RETURNS POLICY (NON-FAULTY GOODS)

Returns must be pre-authorized (if not pre-authorized the return will be rejected). Goods may only be returned direct to us if they were purchased direct from us (customer must prove if necessary). Otherwise to be returned to original vendor. Goods must be in re-sellable condition, in the opinion of R&G Racing. All returns are subject to a 25% restocking and handling fee (25% of the gross value exc. P&P - at the prevailing price at time of purchase). The customer must pay any and all carriage charges. No returns of discontinued products, unless within 14 days of purchase. This policy does not affect your statutory rights and does not refer to faulty goods.

R&G

Unit 1, Shelley's Lane, East Worldham, Alton, Hampshire, GU34 3AQ

Tel: +44 (0)1420 89007 Fax: +44 (0)1420 87301 www.rg-racing.com Email: info@rg-racing.com



FITTING INSTRUCTIONS FOR CLG0023CG/RH FACTORY CARBON LEVER DEFENDER
BMW S1000RR 19-



THIS KIT CONTAINS THE ITEMS PICTURED AND LABELLED BELOW.
DO NOT PROCEED UNTIL YOU ARE SURE ALL PARTS ARE PRESENT.

PLEASE NOTE THAT THE WAY THE KIT IS PACKED DOES NOT NECESSARILY REPRESENT THE WAY OF MOUNTING TO THE BIKE

PLEASE NOTE THAT IN CASES WHERE KITS ARE PACKED WITH RUBBER WASHERS HOLDING THE COMPONENTS ONTO THE BOLT – *THE RUBBER WASHERS SHOULD BE THROWN AWAY!*

THE PARTS SHOWN MAY BE REPRESENTATIVE ONLY (FOR CLARITY OF INSTRUCTIONS ONLY)

DIGITAL COPIES OF THESE INSTRUCTIONS ARE AVAILABLE TO DOWNLOAD FROM WWW.RG-RACING.COM

GENERAL TORQUE SETTINGS

M4 BOLT = 8Nm
M5 BOLT = 12Nm
M6 BOLT = 15Nm
M8 BOLT = 20Nm
M10 BOLT = 40Nm

TOOLS REQUIRED

- T40 Torx Key/Socket
- 24mm A/F Hex Spanner
- 4mm A/F Allen Key

THIS KIT CONTAINS:

- Item 1 = 1x CARBON LEVER GUARD (LG0005COMP).
Item 2 = 1x MOUNTING SLEEVE (M0586)
Item 3 = 1x MOUNTING BLOCK (M0585)
Item 4 = 1x CONE SPACER (S0781)
Item 5 = 1x CLAMP SPACER (S0928)
Item 6 = 1x M6 x 1.00 x 50mm LONG STAINLESS-STEEL COUNTERSINK BOLT

R&G

Unit 1, Shelley's Lane, East Worldham, Alton, Hampshire, GU34 3AQ
Tel: +44 (0)1420 89007 Fax: +44 (0)1420 87301 www.rg-racing.com Email: info@rg-racing.com

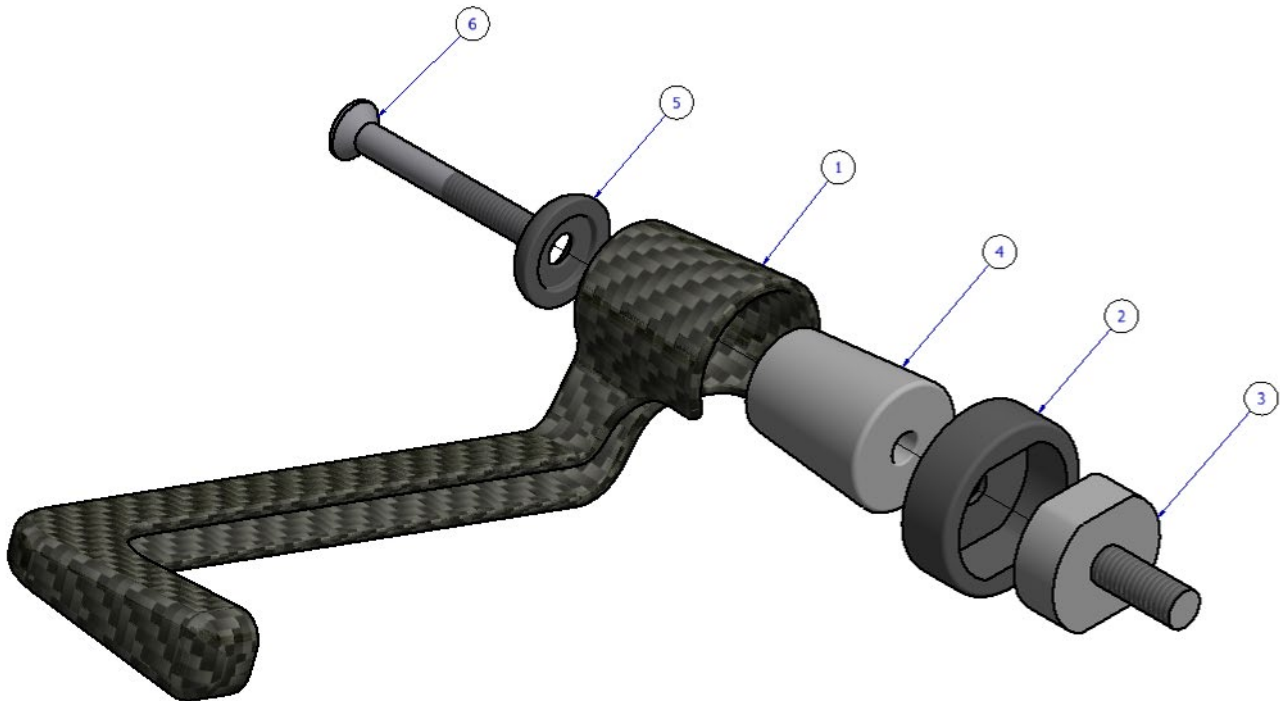

LEVER GUARD EXPLODED ASSEMBLY

- Remove the RHS OEM bar-end using a T40 Torx key/socket.
- Fit the mounting block (item 3) into the vacant M8 hole by winding in by hand, then tighten using a 24mm spanner across the flat faces of the block.
- Pre-assemble the lever guard as shown in the diagram above. Slide the cone spacer (item 4) into the bore of the lever guard (item 1), then push the countersink bolt (item 6) through the clamp spacer (item 5) and through the hole in the lever guard.
- Finally, assemble the lever guard as shown in the diagram above. Slide the sleeve (item 2) over the block, then secure the pre-assembled lever guard to the block using a 4mm Allen key and position so when the motorcycle is at full lock in both directions it does not contact any other part of the motorcycle.
- Fully tighten the bolt and check operation.

IMPORTANT: - WHEN FITTING THIS PRODUCT IT IS YOUR RESPONSIBILITY TO ENSURE THAT THE PRODUCT IN NO WAY IMPEDES THE OPERATION OF THE MOTORCYCLE AND IS CHECKED REGULARLY FOR TIGHTNESS AND OPERATION.

FAILURE TO CHECK THE ABOVE COULD RESULT IN SERIOUS INJURY OR DAMAGE.

ISSUE 1 - 10/01/2022

R&G

Unit 1, Shelley's Lane, East Worldham, Alton, Hampshire, GU34 3AQ
 Tel: +44 (0)1420 89007 Fax: +44 (0)1420 87301 www.rg-racing.com Email: info@rg-racing.com

**CONSUMER NOTICE**

The catalogue description and any exhibition of samples are only broad indications of the Products and R&G may make design changes which do not diminish their performance or visual appeal and supplying them in such state shall conform to the order. The Buyer acknowledges no representation or warranty (other than as to title) has been given or will apply to the Products other than those in R&G's order or confirmation and the Buyer confirms it has chosen the Products as being of merchantable quality and suitable for its particular purposes. Where R&G fits the Products or undertakes other services it shall exercise reasonable skill and care and rectify any fault free of charge unless the workmanship has been disturbed. The Buyer is responsible for ensuring that the warranty on the motorcycle is not affected by the fitting of the Products. On return of any defective Products R&G shall at its option either supply a replacement or refund the purchase money but shall not be liable if the Products have been modified or used or maintained otherwise than in accordance with R&G's or manufacturer's instructions and good engineering practice or if the defect arises from accident or neglect. Other than identified above and subject to R&G not limiting its liability for causing death and personal injury, it shall not be liable for indirect or consequential loss and otherwise its liability shall be limited to the amounts paid by the Buyer for the Products or the fitting or service concerned. These terms do not affect the Buyer's statutory rights.

R&G RACING RETURNS POLICY (NON-FAULTY GOODS)

Returns must be pre-authorized (if not pre-authorized the return will be rejected). Goods may only be returned direct to us if they were purchased direct from us (customer must prove if necessary). Otherwise to be returned to original vendor. Goods must be in re-sellable condition, in the opinion of R&G Racing. All returns are subject to a 25% restocking and handling fee (25% of the gross value exc. P&P – at the prevailing price at time of purchase). The customer must pay any and all carriage charges. No returns of discontinued products, unless within 14 days of purchase. This policy does not affect your statutory rights and does not refer to faulty goods.

R&G

Unit 1, Shelley's Lane, East Worldham, Alton, Hampshire, GU34 3AQ
Tel: +44 (0)1420 89007 Fax: +44 (0)1420 87301 www.rg-racing.com Email: info@rg-racing.com



**INSTRUCTIONS DE MONTAGE POUR CLG0023CG/RH DEFENDER À LEVIER DE CARBONE
D'USINE
BMW S1000RR 19-**



**LE KIT CONTIENT LES ARTICLES EXPOSÉS CI-DESSOUS, VÉRIFIER QUE TOUTES LES PIÈCES SOIENT PRÉSENTES AVANT DE
PROCÉDER AU MONTAGE.**

**LA FAÇON DONT LE KIT EST EMBALLÉ NE CORRESPOND PAS FORCÉMENT À LA FAÇON DE MONTER LES
PIÈCES SUR LA MOTO.**

NOTEZ QUE SI LES KITS SONT EMBALLÉS AVEC DES RONDELLES EN CAOUTCHOUC SERVANT À TENIR LES
COMPOSANTS, *CES RONDELLES DOIVENT ÊTRE JETÉES!*

LES PARTIES PRÉSENTÉES PEUVENT ÊTRE UNIQUEMENT REPRESENTATIVES (POUR LA CLARTE DES INSTRUCTIONS
UNIQUEMENT)

NOTICE DISPONIBLE AU TÉLÉCHARGEMENT SUR WWW.RG-RACING.COM

VALEURS DE SERRAGE RECOMMANDÉES

M4 BOULON = 8Nm
M5 BOULON = 12Nm
M6 BOULON = 15Nm
M8 BOULON = 20Nm
M10 BOULON = 40Nm

OUTILS REQUIS

- Clé Torx T40
- Clé à molette 24mm
- Clé Allen 4mm

LE KIT CONTIENT :

Article 1 = 1x PROTECTION POIGNEE EN FIBRE DE CARBONE (LG0005COMP).
Article 2 = 1x MANCHON (M0586)
Article 3 = 1x BLOC DE MONTAGE (M0585)
Article 4 = 1x ENTRETOISE CONIQUE (S0781)
Article 5 = 1x ENTRETOISE (S0928)
Article 6 = 1x M6 x 1.00 x 50mm BOULON

R&G

Unit 1, Shelley's Lane, East Worldham, Alton, Hampshire, GU34 3AQ
Tel: +44 (0)1420 89007 Fax: +44 (0)1420 87301 www.rg-racing.com Email: info@rg-racing.com

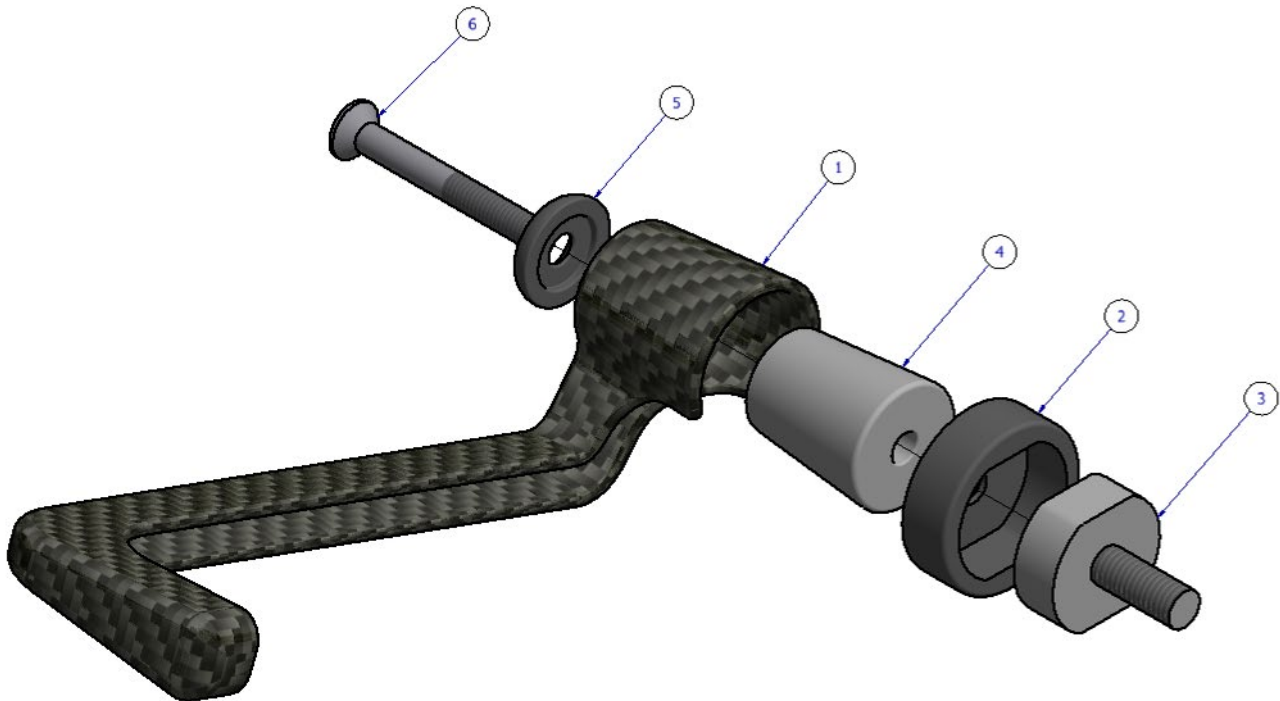

MONTAGE DE LA PROTECTION LEVIER

- Retirez l'extrémité de guidon d'origine du côté droit à l'aide d'une clé / douille Torx T40.
- Insérez le bloc de montage (article 3) dans le trou M8 vacant en le remontant à la main, puis serrez à l'aide d'une clé plate de 24 mm sur les faces planes du bloc.
- Prémontez le protège-levier comme indiqué sur le schéma ci-dessus. Faites glisser l'entretoise conique (article 4) dans l'alésage du protège-levier (article 1), puis poussez le boulon (article 6) à travers l'entretoise de serrage (article 5) et à travers le trou du protège-levier.
- Enfin, assemblez le protège-levier comme indiqué sur le schéma ci-dessus. Faites glisser le manchon (article 2) sur le bloc, puis fixez le protège-levier pré-assemblé au bloc à l'aide d'une clé Allen de 4 mm et positionnez-le de sorte que, lorsque le guidon de la moto est complètement verrouillée dans les deux sens, elle ne touche aucune autre partie de la moto.
- Serrez complètement le boulon et vérifiez son fonctionnement.

IMPORTANT : - IL EST DE VOTRE RESPONSABILITE DE CONTROLER QUE CE PRODUIT NE GENERA PAS LE FONCTIONNEMENT DE LA MOTO, ET DE VERIFIER REGULIEREMENT SON SERRAGE.
NE PAS EFFECTUER CES VERIFICATIONS PEUT CAUSER DES DOMMAGES POUR LA MOTO ET SON PILOTE.

ISSUE 1 - 10/01/2022

R&G

Unit 1, Shelley's Lane, East Worldham, Alton, Hampshire, GU34 3AQ
Tel: +44 (0)1420 89007 Fax: +44 (0)1420 87301 www.rg-racing.com Email: info@rg-racing.com

CONSUMER NOTICE

The catalogue description and any indications of the Products and R&G may diminish their performance or visual appeal conform to the order. The Buyer warranty (other than as to title) has been given or will apply to the Products other than those in R&G's order or confirmation and the Buyer confirms it has chosen the Products as being of merchantable quality and suitable for its particular purposes. Where R&G fits the Products or undertakes other services it shall exercise reasonable skill and care and rectify any fault free of charge unless the workmanship has been disturbed. The Buyer is responsible for ensuring that the warranty on the motorcycle is not affected by the fitting of the Products. On return of any defective Products R&G shall at its option either supply a replacement or refund the purchase money but shall not be liable if the Products have been modified or used or maintained otherwise than in accordance with R&G's or manufacturer's instructions and good engineering practice or if the defect arises from accident or neglect. Other than identified above and subject to R&G not limiting its liability for causing death and personal injury, it shall not be liable for indirect or consequential loss and otherwise its liability shall be limited to the amounts paid by the Buyer for the Products or the fitting or service concerned. These terms do not affect the Buyer's statutory rights.



exhibition of samples are only broad make design changes which do not and supplying them in such state shall acknowledges no representation or

R&G RACING RETURNS POLICY (NON-FAULTY GOODS)

Returns must be pre-authorized (if not pre-authorized the return will be rejected). Goods may only be returned direct to us if they were purchased direct from us (customer must prove if necessary). Otherwise to be returned to original vendor. Goods must be in re-sellable condition, in the opinion of R&G Racing. All returns are subject to a 25% restocking and handling fee (25% of the gross value exc. P&P – at the prevailing price at time of purchase). The customer must pay any and all carriage charges. No returns of discontinued products, unless within 14 days of purchase. This policy does not affect your statutory rights and does not refer to faulty goods.

R&G

Unit 1, Shelley's Lane, East Worldham, Alton, Hampshire, GU34 3AQ
Tel: +44 (0)1420 89007 Fax: +44 (0)1420 87301 www.rg-racing.com Email: info@rg-racing.com